

Remote-controlled tracked self-propelled lawn mower

Applicable to 9ZGD/MC series

Product Manual

Jiangsu Maibu Intelligent Equipment Technology Co., Ltd.

Preface

- (1) Thank you very much for choosing and using our company's products!
- (2) All information in this document is copyrighted by Jiangsu Maibu Intelligent Equipment Technology Co., Ltd. No part of this document may be reproduced in any commercial manner.
- (3) Jiangsu Maibu Intelligent Equipment Technology Co., Ltd. makes no express or implied warranties or guarantees with respect to any equipment and software described in this document, including but not limited to any implied warranties of merchantability, commerciality, or fitness for any particular purpose. In no event shall Jiangsu Maibu Intelligent Equipment Technology Co., Ltd. or its distributors or dealers be liable for indirect, incidental losses.
- (4) Jiangsu Maibu Intelligent Equipment Technology Co., Ltd. strictly complies with local regulatory requirements, and all products meet local regulatory standards.
- (5) Please follow the instructions in this user manual for using and operating the battery and electronic control system, otherwise it may affect the protection design of the system and invalidate the system's warranty commitment.
- (6) The specifications in this document are subject to change without notice. We have made every effort to make this document complete, accurate and up-to-date. However, in some cases, some improvements may be necessary without prior notice.
- (7) To facilitate reading this manual, a large number of pictures are configured in the manual. The pictures are for illustrative purposes only, and the specific details of the product are subject to the actual product received.
- (8) All descriptions in this manual are standard configurations of the lawn mower. If users have special needs, please explain to the staff of Jiangsu Maibu Intelligent Equipment Technology Co., Ltd. when ordering. We will do our best to meet your needs. The specific details of the product are

subject to the actual product you receive.

- (9) This manual cannot cover all possible situations in the installation, operation, maintenance, overhaul and other processes. If you encounter situations that are not explained in the manual, please contact Jiangsu Maibu Intelligent Equipment Technology Co., Ltd. in time.
- (10) In order to use this product more safely and efficiently, this manual introduces in detail the safety precautions, technical parameters, driving operation, maintenance (inspection) methods of the machine. Please read it carefully and use this product correctly on the basis of understanding.

Key points to note:

- 1. This product has potential dangers. Do not operate, maintain, or inspect this product before reading and understanding this manual.
- 2. In order to be able to perform correct operation, maintenance and inspection of this product at any time, be sure to do so according to the requirements of this manual and keep this manual properly.

Jiangsu Maibu Intelligent Equipment Technology Co., Ltd. assumes no responsibility for any losses caused by this document, including but not limited to omissions, printing errors, arithmetic errors or listed errors in this document.

Jiangsu Maibu Intelligent Equipment Technology Co., Ltd. has the final right to interpret all the contents in this user manual.

If you have any suggestions for improving our company's products, please contact us in a timely manner. Thank you again!

Version History

The latest version in the revision history includes updates from all previous document versions.

V1 2022-12-08 First Release

Table of Contents

I. Safety Warnings and Precautions for Use	1
1.1 Special Warnings	1
1.2 Explanation of Warning Labels on This Product	2
1.3 Safety Operation Instructions	4
1.4 Safe Driving and Safe Operation Instructions	5
II. Product Introduction	9
2.1 Component Names and Functions	9
2.2 Control Panel Functions	10
2.3 Technical Parameters	12
2.4 Attached Parts List	13
2.5 Optional Accessories	13
3. Machine Operation Instructions	15
3.1 Preparation Before Starting	15
3.2 Starting Method	16
3.3 Mowing Method	18
3.4 Parking Method	19
3.5 Remote Control Usage	20
4. Maintenance and Repair	25
4.1 Periodic Inspection Checklist	25
4.2 Inspection of Traveling and Mowing Components	26
4.3 List of Refueling, Water Filling, Greasing, and Oil Lubrication	27
4.4 List of Consumable Parts (Replacement Parts)	28
4.5 Engine	28
4.6 Traveling Device	31
4.7 Post-Use Maintenance	32
5. Troubleshooting	34
5.1 Problem Diagnosis Table	34
5.2 Status Display Description Table	38
VI. Key Points for Handling This Product	41
VII. About Warranty and After-sales Service	42
7.1 About Warranty	42
7.2 About After-sales Service	42
7.3 About the Supply Period of Parts (Duration)	43

I. Safety Warnings and Precautions for Use

1.1 Special Warning

1. This product is a professional lawn mower. It is strictly forbidden to use it for other purposes without permission, except for mowing.
2. This product is prohibited from driving on roads, national highways, and other roads. Our company is not responsible for any traffic accidents caused by driving on roads.
3. Please do not modify this product. Additionally, to avoid accidents, do not disassemble parts, especially the control box cover and the whole machine protective cover, etc. This can easily cause accidents.
4. Before using the remote control function, please turn on the power of the whole machine first. When turning on the remote control, you must rotate the emergency stop knob of the remote control clockwise to pop it up, and long press the “Turn On” remote control button for 3 seconds. When turning off the remote control, long press the “Turn Off” remote control button for 3 seconds.
5. **If clicking the remote control button does not work during operation, please long press the “Turn On” remote control button for 2 seconds, and then operate; if it still does not work, please stop immediately and restart the remote control system.**
6. This machine has its own remote control protection system. Due to the complex outdoor operating environment, wireless signals are easily interfered with. When the remote control signal is severely interfered with or exceeds the remote control range, the machine will automatically stop walking and mowing; move the position and restart the remote control after confirming that the remote control communication is normal.
7. **This machine comes with a battery voltage display. When the power or voltage is too low (voltage below 45V), please replace the battery or charge the battery in time; if it is not used for a long time, turn it on once a month to check the voltage. If it is lower than 45V, please charge it in time to avoid over-discharge and damage to the battery cells.**
8. The remote control uses a special rechargeable battery. If it is not used for a long time, please take it out and charge it in time!

1.2 Warning Label Instructions for this Product

This product will be affixed with the following warning labels. The warning labels specifically record safety precautions that must be observed when using this product. Do not do anything that is prohibited.

Please read the contents of the warning label carefully.



To facilitate understanding of the contents of the warning label, please keep the label clean.

If the warning label is damaged, lost, or unclear, please replace it with a new one.

Confirm according to this manual or things and contact the sales network.

Advice for Renters

Note: When providing this product for rental services to others, please explain the usage method of this product in detail and be sure to read this manual before use.

1.3 Safety Operation Instructions

To use this product safely, it is essential to pay attention to preventing poisoning, fire, and machine accidents. It is imperative to attach great importance and be highly vigilant, and never be careless. To ensure personal safety, the following precautions should be observed:

1. Be sure to read the instruction manual before operating this product and pay attention to warning signs.
2. Before operating this product, be sure to familiarize yourself with it in an open area to avoid accidental operation or collision.
3. Operators must wear safety clothing, protective glasses, gloves, earplugs, and safety helmets.
4. When working, no other personnel should be working around the machine to prevent accidents.
5. This machine uses gasoline as fuel, which is flammable, so pay attention to fire prevention. It is strictly forbidden to ignite or smoke near the gasoline engine. It is strictly forbidden to disassemble batteries and other accessories.
6. After refueling, be careful to tighten the fuel tank cap. If there is any fuel leakage, wipe it clean and move the machine away from the refueling point before starting.
7. It is forbidden to add or pour out fuel while the gasoline engine is running.
8. When operating this product, do not touch the muffler or cylinder block with your hands to avoid burns and accidents.
9. Do not start abruptly, accelerate rapidly, turn sharply, or stop suddenly. This can easily cause the operator to be thrown off or the vehicle to skid or overturn.
10. When on a sloping road, it is recommended to drive at a low speed to avoid skidding or overturning.
11. This product uses a belt for transmission. The machine cover must be closed during operation to ensure personal safety.
12. Before storage, drain the fuel from the fuel tank and carburetor, wipe the machine clean, and store it in a ventilated place away from fire.
13. Store it in a place out of reach of children to avoid accidents.
14. Do not use strong acids, strong alkalis, or other special working fluids.
15. After work, operators should wash exposed parts of their bodies and clean all types of clothing and gear.
16. The following personnel are prohibited from operating this product:
People with mental illness; intoxicated people; people with no operating knowledge; minors or the elderly;
Pregnant or lactating women; those who are excessively fatigued.

1.4 Safety Driving and Operation Instructions

This section records the general safety precautions that must be followed during driving and operation. During driving and operation, the safety precautions specified in each chapter must be followed, and it must always be kept in mind to drive safely and operate safely.

Precautions Before Driving

Please wear safety clothing and protective gear.

When driving and operating, please wear clothing suitable for the work, and do not wear light clothing such as vests, shorts, and slippers. Also, wear protective shoes, protective glasses, gloves, etc., and make safety preparations.

When working for long periods, in order to reduce the harm of noise to the human body, it is recommended that operators wear earplugs to prevent noise.

Pre-operation Inspection

Before driving and operating, please perform the necessary inspection work. If you find any abnormalities, please repair them immediately. In addition, before driving and operating, please check and clean up the weeds accumulated in the vehicle to prevent fire.

No open flames

When refueling or extracting fuel, keep away from fire. When refueling, make sure the vehicle is turned off. When performing engine maintenance or charging the battery, it is strictly forbidden to approach fire.

Do not drive on public roads.

Do not ride.

This product is not for passenger use.

Do not drive recklessly.

Do not work while drinking alcohol or if you are feeling unwell. Also, do not allow personnel who are unfit to drive or operate the equipment to do so.

Ensure work safety (No entry).

When driving or operating, keep people (especially children) away from the product, maintaining a distance of at least 5m. If necessary, place a sign at the work site stating "Mowing in progress" or "Keep away."

Before driving or operating, please check the condition of the machine for any unusual noises or loose parts to ensure work safety.

Do not start or drive in poorly ventilated areas.

When starting the engine, be sure to do so in a well-ventilated area to prevent exhaust poisoning.

Please start 5 meters away from this product

Please start at least 5 meters away from the vehicle to prevent scratches.

Prohibited: sudden acceleration, sharp turns, sudden stops

Please do not perform dangerous operations such as sudden starts, sudden acceleration, sharp turns, and sudden braking. It can easily cause the vehicle to slip, overturn, and other accidents.

Compliance with safe speed

When moving forward, please confirm the safety of the surroundings, and when driving, please confirm the road conditions and drive at a safe speed.

Recommended to operate on a slope

When the machine is working on a slope, please operate on the upper side of the slope.

Do not work directly below the machine

When the machine is working on a slope, do not stand directly below the machine when operating below the slope.

Do not open the cutter guard during operation

Do not open the cutter cover during operation. Small stones and other debris that fly out can scatter around and cause danger.

Caution: Sloping surface

When driving on a sloping surface, select "low gear" for driving or turning. Otherwise, it is easy to cause the vehicle to slip or overturn.

Do not use on steep slopes

Be sure to check and clean the grass collection inside the machine in time

When mowing in harsh environments or areas with a lot of grass, pay attention to the accumulation of grass clippings inside the machine, especially in the exhaust area, engine fan, and inside the generator, and clean it in time.

Note: Accumulated grass clippings will reduce the ventilation of the engine and generator. Failure to clean for a long time will reduce the engine and generator's performance and shorten the machine's service life.

Caution: Slippery road surface, causing the vehicle to slip

Caution: Ground obstacles, prevent collision damage

Caution: Uneven ground, causing the vehicle to twist and deform

Beware of landslides

Please do not work on roadsides or near ditches. Landslides and other accidents are likely to occur, especially after rain or earthquakes.

Safety confirmation when parking

When parking, be sure to turn off the power of the machine and the remote control.

Parking prohibited in dangerous places

When parking, please choose a flat surface. Do not park in dangerous places. Also, do not park near flammable materials.

When parking on a sloping surface, secure the wheels

Please do not park on sloping surfaces. If you have to park, please secure the wheels.

Cleaning after use

After use, please remove weeds and other debris accumulated under the vehicle to prevent fire.

Please turn off the engine during maintenance inspection

Always turn off the power before performing maintenance or inspecting the vehicle.

Beware of burns

After the engine is turned off, various parts are in a high-temperature state and can easily cause burns. Please wait for the vehicle to cool down before performing maintenance.

This product is prohibited from being driven on roads such as highways and national roads.

II. Product Introduction

2.1 Component Names and Functions

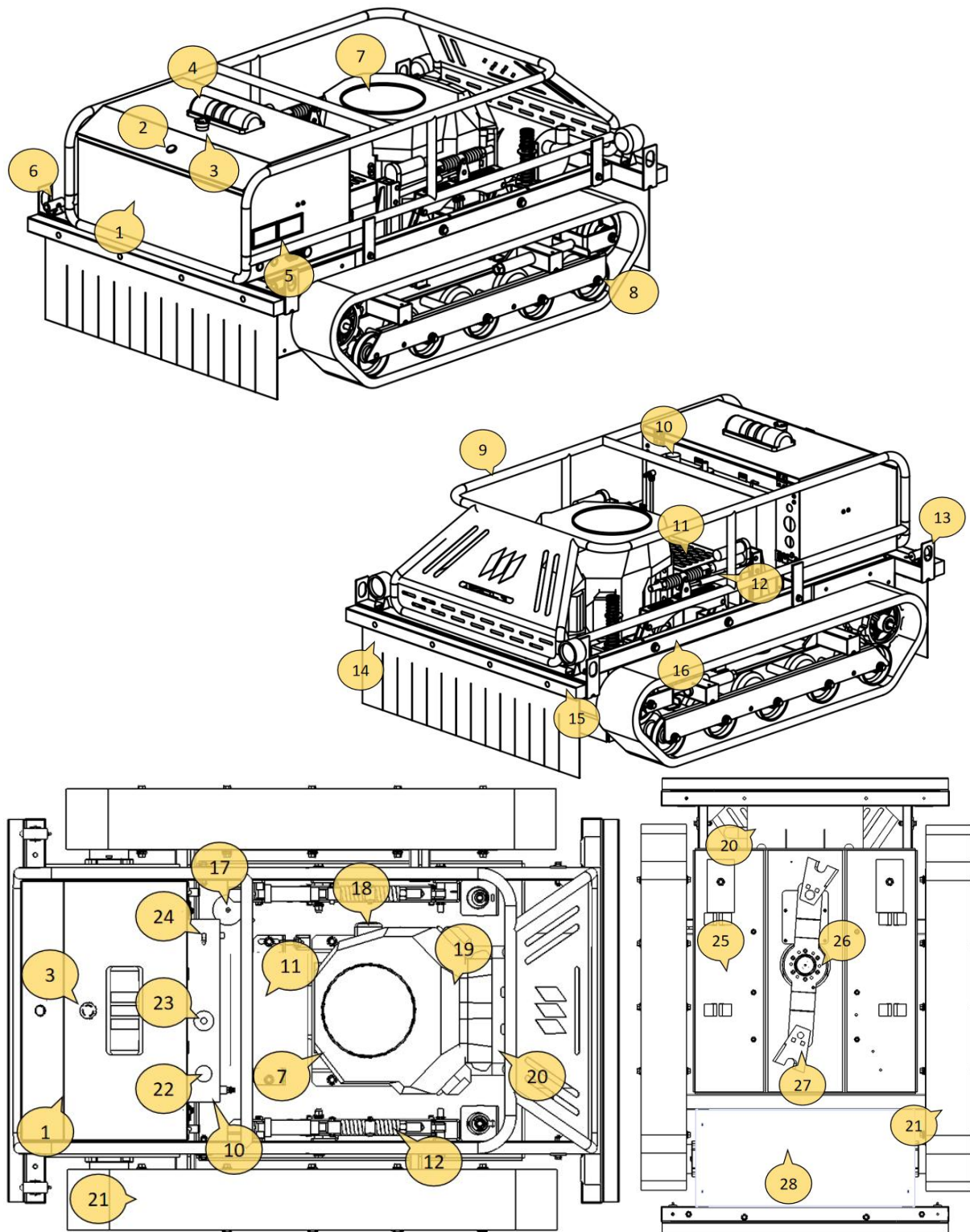

Serial Number	Component Name	Serial Number	Component Name	Serial Number	Component Name	Serial Number	Component Name
1.	Control Box	2.	Control Box Lock	3.	Emergency stop switch	4.	Three-color light
5.	Control panel	6.	Rear light	7.	Engine	8.	Track support assembly
9.	Protection beam	10.	Fuel tank	11.	Generator	12.	Lifting assembly
13.	Rings	14.	Straw curtain	15.	Baffle strip	16.	Frame assembly
17.	Antenna	18.	Oil filter	19.	Air filter	20.	Muffler
21.	Crawler	22.	Oil filler	23.	Oil level sensor	24.	Oil outlet
25.	Cutting disc	26.	Cutting handle	27.	Cutter	28.	Motor compartment

2.2 Control Panel Functions

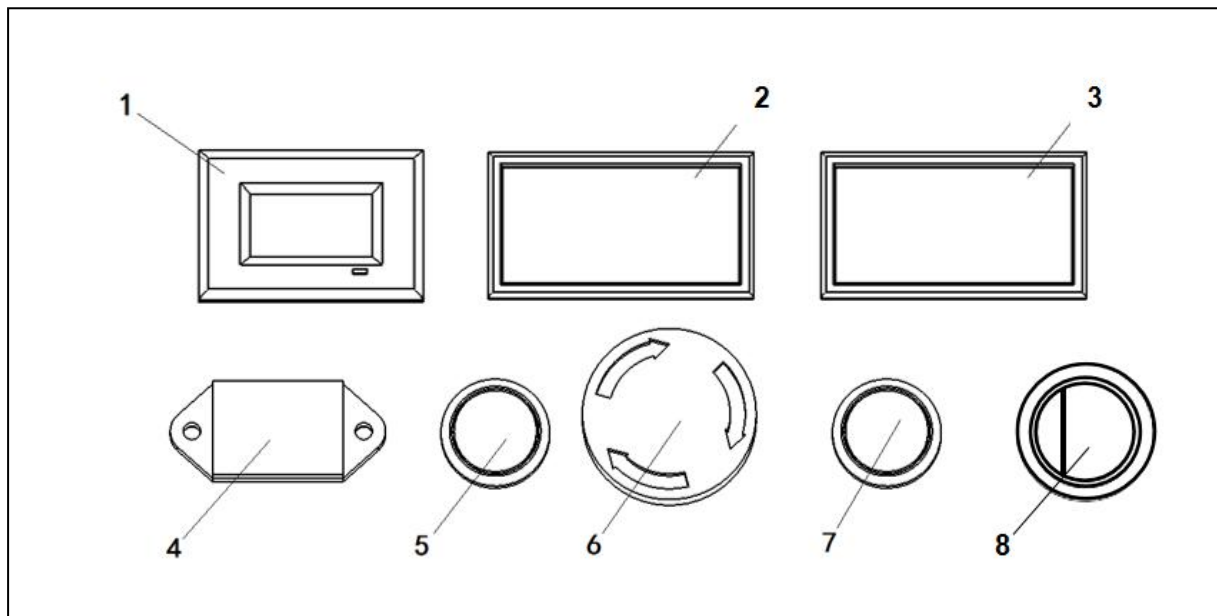

1. Accumulator: Displays the working hours of the gasoline engine. When the maintenance time is reached, the screen font will flash, and it is necessary to stop the machine and maintain the engine (because the control system has recorded the working time, see the 5.2 display description table for specific usage methods. Some models are no longer

equipped with accumulators, and no additional notice will be given).

2. Temperature display: Real-time display of the electrical control box temperature, higher than the limit temperature (65°C), triggers the indicator light and buzzer.
3. Voltage display: Real-time display of the battery's working voltage. When the power or voltage is too low in a non-working state (below 45V), stop and charge.
4. Charging port: For battery charging, be sure to use the original matching battery charger.
5. Power Button: Controls power on/off. In an emergency stop release situation, if you press this button, the device will power on and the power indicator light will illuminate. If you press and hold this button for 2s and then release it, the power indicator light will flash, the device will power off, and the power indicator light will turn off.
6. Emergency stop button: Used when the equipment malfunctions. Press the emergency stop button to immediately stop the equipment. If you need to restart, rotate the emergency stop button clockwise after troubleshooting the abnormal situation. The emergency stop button will pop up and unlock, and the equipment can be used normally.
7. DragButton: Used to release the wheel brake. If the lawn mower fails, you can press this button. When the indicator light on the button is on, the wheel brake is released. Then press the emergency stop button to drag the lawn mower. If you press the button again, the button will pop up and reset, and the indicator light on the button will go out, then the wheel brake will be locked and the lawn mower cannot be dragged.
8. External power supply: For external power equipment, pay attention to the rated output voltage of DC24V and the maximum current of 20A. Please do not overload it.

2.3 Technical parameters

Name		Unit	Remote-controlled self-propelled lawn mower
Vehicle information	Model		9ZGD-680
	External dimensions (length×width×height)	mm	1420×1090×650
	Vehicle weight	kg	320
	Working efficiency	m ² /h	2500*
	Recommended working speed	km/h	3
	Minimum ground clearance	mm	40
	Range (electric only)	h	0.4
	Rated load	kg	500 (flat ground)
Engine	Type		Air-cooled, four-stroke, twin-cylinder, vertical shaft gasoline engine
	Power	kW/rpm	Maximum power 15.5/3600 Continuous operation 10.5/3000 Continuous work 12/3600
	Maximum torque	Nm/rpm	48.3/2500
	Starting mode		Remote control one-key start
	Total displacement		688
	Fuel tank capacity	L	10
	Oil capacity	L	1.9
Driving performance	Drive mode		Single drive
	Power	kW	3
	Crawler	Model	150×60
	Driving speed	km/h	0-4
	Brake		Yes
	Brake release		Yes
	Minimum turning radius	m	0
	Variable angle braking		Yes
	Variable speed braking		Yes
	Climbing ability	°	≤35
	Left and right inclination	°	≤35
	Straight line keeping		Yes
Mowing device	Cutting width	mm	700
	Cutting height	mm	5-90
	Cutting Knife Form		Segmented
	Number of Cutting Knives		2
	Grass Discharge Outlet		2 (Front and Rear)
	Protection Method		Clutch
Electrical	Remote Control		Digital Display
	Remote Control Distance	m	≤200

Performance	Cell Composition		SLA
	Battery Information	V/AH	48/23
	Controller		Automotive-grade ECU
	Protection Level		Automotive grade
Safety protection	Maximum safe tilt angle	°	45
	Remote Control		Drop protection

* Actual mowing efficiency at low speed (may vary depending on terrain and weed type)

2.4 Subsidiary Schedule

Serial Number	Name	Quantity	Remarks
1.	Handheld remote control	1 piece	
2.	Remote control waist strap	1 piece	
3.	Remote control charger	1 piece	
4.	Lawn mower charger	1 piece	
5.	Electrical control box key	1 piece	
6.	Fuel tank cap key	2 pieces	
7.	Engine manual	1 book	
8.	Complete machine instruction manual	1 book	This book
9.	Three Guarantees Service Manual	1 book	

2.5 Optional accessories

Name	Unit	Quantity	Parameter index
Complete machine protection frame	piece	1	25mm steel pipe
Cargo carrier	piece	1	
Cargo trailer	Platform	1	
Collision buffer rubber strip	Strip	1	
Collision parking protection sensor	Strip	1	
Front headlight	Pair	1	
Rear light	Pair	1	

Remote control battery	piece	1	
Remote control battery charger	piece	1	Cloverleaf plug, 220V/8.45V1.5A
Remote control battery charger	piece	1	Cigarette lighter interface, 220V/8.45V1.5A

III. Machine Usage Instructions

3.1 Preparation Before Starting

Pre-start Inspection

A vehicle body inspection must be performed before starting. If any abnormalities are found, they must be dealt with immediately.

Please clean weeds and other debris from the vehicle body to prevent fires and other accidents.

Excessive accumulation of weeds at the air inlet and exhaust outlet of the engine and generator can cause the engine to overheat and the vehicle body to malfunction. Before operation, be sure to carefully check whether there are foreign objects accumulated at the air inlet and exhaust outlet of the engine and generator. If there is any accumulation, please clean it up in time.

Please refer to the [Periodic Inspection Checklist] for periodic inspection content.

Fuel Inspection and Refueling, Electricity Detection and Charging



Warning

- Keep away from fire when refueling.
- When refueling, be sure to do so with the engine stopped.
- When refueling, be careful not to exceed the oil level (the bottom surface of the filter at the refueling port), and be careful not to spill oil outside the refueling port. If there is any leakage, wipe it off immediately.
- When charging, use a standard 220V voltage and do not operate in violation of regulations.
- When charging, check for flammable materials nearby and stay away from dangerous places.
- Pay attention to ventilation when charging.
- The charging place should be placed in a place where children cannot easily touch it, and be careful of potential dangers.

- 1) Please check whether the oil and electricity are normal.
- 2) Please confirm the power meter. If it is insufficient or below 45V, charge it in time.
- 3) Please confirm the fuel level. If it is insufficient or an alarm occurs, open the fuel cap and refuel in time. After filling, close the fuel cap.
- 4) Check the total working time of the machine and whether the engine oil condition is normal. If the engine oil is turbid, replace it in time.

Suggestion:

- **Fuel Use: The car uses unleaded gasoline with an octane rating of 91 or higher, or unleaded gasoline with an ethanol content not exceeding 10% (E10).**
- **Fuel tank capacity:10L.**
- **Engine oil: Add four-stroke engine oil for automobiles to the middle position of the dipstick's cursor. Change the grade according to the season.**
- **Oil capacity**

Without oil filter replacement: 1.7 L, with oil filter replacement: 1.9 L

- 1) Check whether the connections of each part of the machine are firm, and whether the bolts are loose. If there is any looseness, tighten them in time.
- 2) Check each fastener to ensure that the engine, etc., is firmly mounted on the frame. Check if the pulley is loose and the belt is properly tightened.
- 3) Check whether there are weeds or other foreign objects inside the machine that have not been cleaned. If there are any foreign objects, clean them in time.
- 4) Check whether the indicator light is normal. The red light of the lawn mower flashes when starting; the green light is always on when the lawn mower and the remote control are successfully connected; the yellow light is always on when the lawn mower is in working condition; the indicator light flashes and the buzzer alarms when the lawn mower fails. See the indicator light status table for specific faults.
- 5) Whether the cutting disc is raised to the highest position.

3.2 Starting method



Warning

- **Before starting the lawn mower, make sure the surrounding area is safe and retreat to 5m away.**
- **The engine must be started in a well-ventilated area to avoid exhaust poisoning accidents.**
- **Make sure the surroundings are safe before starting the engine.**
- **When starting the engine, make sure it is on a flat area free of foreign objects**

such as stones and in a parked state. Avoid damage to the cutter or flying stones, etc., causing injury to the user or third parties when starting.

Walking start

- 1) Machine emergency stop button Rotate clockwise to unlock the whole machine Reset.
- 2) Press the machine power button, and the instrument and indicator light up.
- 3) Check the oil and electricity.
- 4) The tricolor indicator light flashes red, and the machine is waiting for the remote control to connect.
- 5) Turn the remote control emergency stop knob clockwise until the knob pops up, long press the power button on the right side of the remote control until the display on the remote control lights up with Init.....
- 6) Wait for the mower to connect to the remote control. Displaying Connecting indicates that the mower and the remote control are connecting.
- 7) The tricolor indicator light turns green and the remote control display signal icon shows a good signal, indicating that the remote control and the mower are successfully connected and the mower is ready.
- 8) Confirm the status of the remote control walking mode lever. The original position is MT driving mode, and the display shows the MT mark; Upward is AT driving mode, and the display shows the AT mark.

AT driving mode: The direction joystick can control the direction and driving speed. The closer the joystick is to the edge, the greater the speed, and vice versa.

MT driving mode: The direction joystick controls the direction, and the driving speed is adjusted by rotating the speed knob.

Straight line holding function: In AT driving mode, flip the anti-collision switch upwards, push the direction joystick forward and hold for 5s, the mower enters the straight line holding state, release the joystick, and the mower continues to drive straight. To exit this function, click any key to exit.

- 9) Move the direction joystick, the mower travels, and during the travel, the three-color indicator light is yellow.

3.3 Mowing method



Warning

- **Do not approach people around you while driving.**
- **Make sure the surroundings are safe before starting, pay attention to the slope of the road, etc., and run at a safe speed.**
- **Do not start suddenly, accelerate suddenly, or turn sharply to avoid skidding, overturning, and other accidents.**
- **Drive at low speed on sloping roads, otherwise it may cause skidding, overturning and other accidents.**
- **Do not cross sloping surfaces, as this can easily cause the machine to slip or overturn.**
- **Do not turn on sloping surfaces, as this can easily cause the vehicle to reverse, slip, or overturn.**
- **On roads with poor visibility or narrow roads, slopes, undulations, or other poor driving conditions, please follow the instructions of the guide and make safety confirmations before driving.**

Mowing start

- 1) Confirm the safety of the machine in all directions.
- 2) Confirm the driving mode.
- 3) Confirm that the mowing blade is raised to the highest position.
- 4) Confirm that the remote control is working properly.
- 5) Pull up the engine fork switch. Note: Release the button immediately after the engine starts. Each ignition time should not exceed 3s. Excessive time can easily damage the engine. In winter, it is difficult to start the cold engine. You can repeat it 3-5 times, pausing for 5s in between.
- 6) The mowing blade rotates normally, and the machine sound frequency is uniform and normal, indicating a successful start.
- 7) Move the cutting height fork switch up and down to adjust the cutter disc to the desired position.
- 8) Move the cutter speed shift fork switch up and down to adjust the cutter speed to the desired speed.
- 9) The lawn mower travels and starts mowing.

Mowing stops

- 1) Move the engine stop shift fork switch down to turn off the engine.
- 2) **Note:** Wait until the cutter has completely stopped rotating before approaching the machine to inspect it.

3.4 Parking Method



Warning

- Sudden stops are prohibited as they can easily cause the machine to slip and overturn.
- Please park on a flat, hard, and safe surface; do not park on sloping surfaces. If it is unavoidable, the wheels must be secured.
- Please do not park near flammable or explosive materials.

Lawn mower parking and shutdown

- 1) Long press the lawn mower power button for 2s or more, release the power button, the button indicator flashes until it goes off, and the lawn mower shuts down.
 - 2) Press the emergency stop button on the lawn mower to ensure that the vehicle does not malfunction.
 - 3) In particularly urgent situations, press the emergency stop button on the remote control, and the lawn mower will stop. This situation will cause some data loss.
 - 4) Long press the remote control power switch or press the emergency stop button on the remote control until the display goes off, and the remote control shuts down.
 - 5) Press the emergency stop button on the remote control to ensure that the remote control does not malfunction.
- **Note:** If there is no operation on the whole machine for 30min, the vehicle will shut down automatically.
 - **Note:** If you do not use it for a long time, please charge the lawn mower at least once a month, with an interval of no more than 30 calendar days.

3.5 Remote Control Usage

Warning

- Non-professionals should not disassemble the remote control.
- If the remote control is not used for a long time, please remove the batteries and charge them in time.

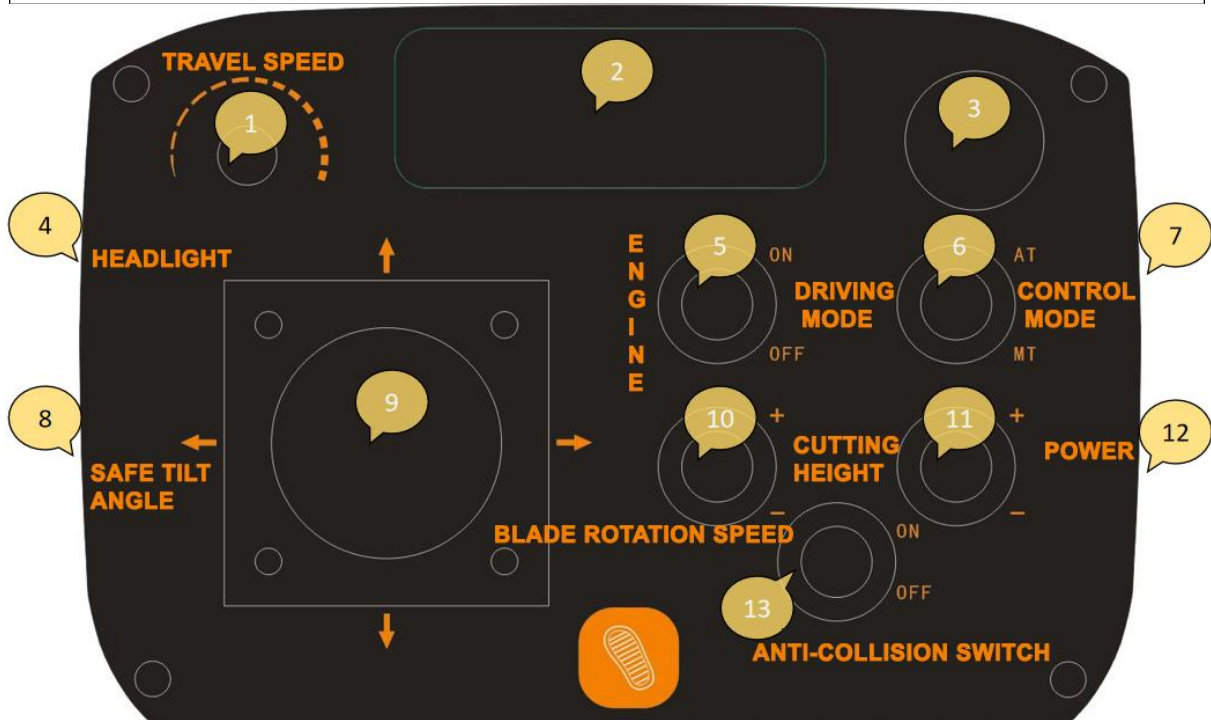

For ease of identification, the serial numbers are numbered in order from left to right and from top to bottom!

- 1 - Speed Control Knob: Rotate clockwise to increase driving speed, and counterclockwise to decrease driving speed.
- 2 - Display Screen: Displays the current status and main parameters of the machine. See the remote control display icon description table and status display description table for details.
- 3 - Emergency Stop Knob: In an emergency, press this button to turn off the remote control, stop the machine, and shut down the engine.
- 4 - Headlights: Press the button to turn on the front and rear lights; press again to turn off the front and rear lights.
- 5 - Engine Start/Stop: Flick up to ignite the engine, flick down to shut down the engine.

The lever automatically returns to the center.

Note: After the engine is ignited and started, release the button immediately. Each ignition time should not exceed 3s. Excessive time can easily damage the engine. If it is difficult to ignite the cold engine in winter, you can repeat it 3-5 times, with a pause of 3s in between.

6 - Walking Mode: Flick the lever up for AT driving mode; flick the lever down for MT driving mode.

7 - Control Mode: Press the button, the machine cannot be remotely controlled and enters the network control mode; press the button again, the machine enters the remote control mode.

Note: This button defaults to remote control mode and does not require operation; please contact the manufacturer in advance for network control mode.

8 - Safety Tilt Angle: The safety tilt angle function is enabled by default. The machine will stop and alarm if it exceeds the safety tilt angle. Press the button to release the safety tilt angle. Press the button again to enable the safety tilt angle.

9 - Direction Joystick: Push up to move forward, push down to move backward, push left to turn left, push right to turn right, and release to stop.

10 - Cutter Speed: Flick up to increase the cutter speed, flick down to decrease the cutter speed, the middle position remains unchanged, and the lever automatically returns to the center.

11 - Cutting Height: Flick up to raise the cutter, flick down to lower the cutter, the middle position height remains unchanged, and the lever automatically returns to the center.

12 - Power: Long press to turn the remote control on or off.

13 - Anti-collision Switch: Flick up to turn on the anti-collision protection function, flick down to turn off the anti-collision protection function.

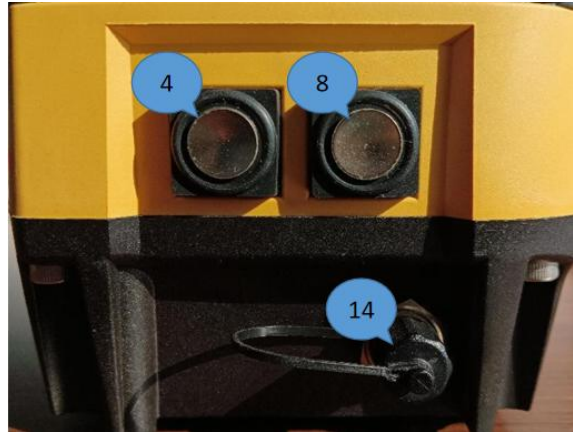

14 - Battery Charging Port: Rotate the lower cap to the right to open, charge, and after charging is complete, rotate the cap to the left to close.

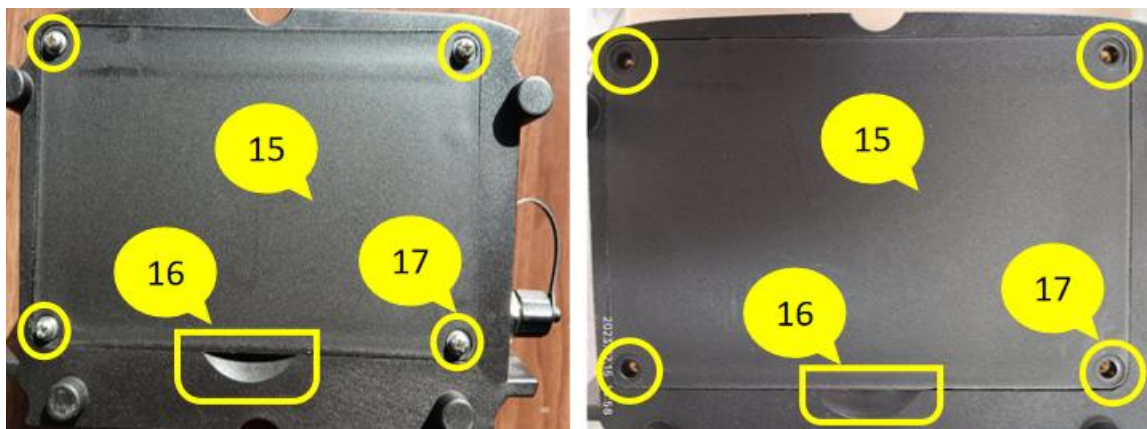

15 - Battery Compartment Cover: Remove the cover after unscrewing the 4 bolts with a screwdriver to replace the battery.

16 - Cover Opening Recess.

17 - Battery Compartment Cover Fixing Bolts.

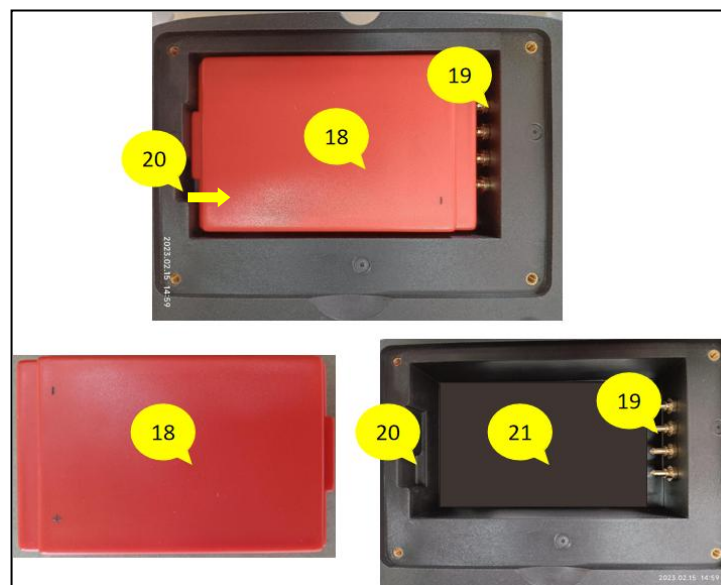

18—Battery: Pay attention to the installation direction and polarity, and do not reverse the connection.

19 - Battery contact point.

20 - Battery removal slot: Use a screwdriver or other tool to press down and then pry in the direction of the arrow to eject the battery.

21 - Battery compartment.

Operating steps

- 1) Install the battery in the remote control, return the "speed control knob" to the zero position, turn up the emergency stop knob, press and hold the power button, the remote control display lights up and enters the main interface, and the status light on the lawn mower lights up green, indicating that the remote control is successfully connected.
- 2) Move the "cutting height" lever upwards to raise the cutter to the highest position, and release the lever.
- 3) Move the "engine" lever upwards to ignite the engine, and release it immediately after successful ignition.
- 4) Adjust the throttle size, cutter height, walking mode, walking speed, anti-collision switch, lighting switch, direction joystick, etc. according to work needs.
- 5) When the work is finished, move the "engine" lever downwards to turn off the engine, press the "emergency stop knob" or press and hold the "power button" to turn off the remote control, and return all switches to the zero position.

Note: Effective remote control distance: 200 meters without interference.

Remote Control Display Icon Description Table

Icon	Description
RM	Remote Mode
TM	Tracking Mode
SA	Safety Angle Alarm Function Enabled
SB	Emergency stop pressed
EI	Engine Ignition

F	Forward
B	Backward
L	Left
R	Right
LF	Forward Left
LB	Backward Left
RF	Forward Right
RB	Rear Right
AT	AT Driving Mode
MT	MT Driving Mode
OK	Self-test successful
IE	Vehicle inclination exceeds standard status
Mm	Maintenance mode
TA	Vehicle high temperature alarm status
LB	Vehicle low battery alarm
LO	Vehicle low fuel alarm
X	Vehicle lateral deviation angle
Y	Vehicle longitudinal deviation angle
CS	Current Vehicle Speed
TH	Total Working Time
PEOT	Pure Electric Running Time
DS	Driving Mileage
EH	Engine Working Time
MR1	Motor speed
ACSI	Drive status
ACV	Drive feedback voltage
VX	Vehicle lateral inclination angle
VY	Vehicle longitudinal inclination angle
VZ	Vehicle heading inclination angle

IV. Maintenance and Repair

4.1 Periodic Inspection Checklist



Attention

- Failure to perform timely inspections and maintenance can cause accidents. To maintain good condition, please refer to the following table for periodic inspections and maintenance.

Engine inspection

1) Daily inspection

- ✓ Fuel inspection
- ✓ Engine oil inspection
- ✓ Inspection of tightness of each screw
- ✓ Abnormal vibration and abnormal sound
- ✓ Inspection of the electronic control system

2) Periodic inspection

Item	Frequency of work
Air filter inspection	2 hours daily (increase inspection frequency in dusty areas)
Air filter cleaning	Every 6 months or 100hours (increase cleaning frequency in dusty areas)
Air filterfilter elementreplacement	Every 2 years or every 500hours (increase replacement frequency in dusty areas)
Cleaning and checking the tightness of each part	Daily8hours (increase inspection frequency in dusty areas)
Engine oil inspection and replenishment	Daily8hours (increase inspection frequency in dusty areas)
Engine oil change	Initially20hours, then every100hours (Increase inspection frequency in dusty areas)
Spark plug cleaning	Every100hours
Fuel filter cleaning	Every200hours
Spark Plug Gap Cleaning and Adjustment	Every200hours
Fuel pipe replacement	Every2years
Generator inspection	2 hours daily (increase inspection frequency in dusty areas)
Cleaning of thegenerator	Daily8hours (increase inspection frequency in dusty areas)
Inspection and replenishment of battery	Daily8hours (increase inspection frequency in frequently used or low-temperature areas)
Overhaul	Every1000hours (please entrust to the sales network)

4.2 Inspection of traveling and mowing parts



Attention

- Be careful not to injure your fingers when disassembling and installing parts.
- When opening or disassembling for inspection and work, it must be restored after the inspection is completed.

Pre-work inspection should be done once a day, monthly maintenance once a month, and annual maintenance once a year.

Item			Inspection Time		
			Each Time	Monthly	Annually
Walking Device	Tires or Tracks	Whether there is obvious damage, aging, or wear	<input type="radio"/>	<input type="radio"/>	<input type="radio"/>
		Are the slack and tension appropriate?	<input type="radio"/>	<input type="radio"/>	<input type="radio"/>
		Are there any deformations or corrosion on the tension nuts?	<input type="radio"/>	<input type="radio"/>	<input type="radio"/>
	Walking gear	Is there any abnormal noise during low-speed idling?		<input type="radio"/>	<input type="radio"/>
	Brake	Is the brake system in normal condition?	<input type="radio"/>	<input type="radio"/>	<input type="radio"/>
		Can it remain stationary on a 30-degree inclined surface when braking?		<input type="radio"/>	<input type="radio"/>
		Is the condition of the shaft normal, and are there any abnormal noises or heat?	<input type="radio"/>	<input type="radio"/>	<input type="radio"/>
		Are the mounting screws and nuts loose or missing?	<input type="radio"/>	<input type="radio"/>	<input type="radio"/>
	Rod, connecting rod, Metal wire	Are there any deformation damages on rods, connecting rods, and metal wires?		<input type="radio"/>	<input type="radio"/>
		Are there any looseness in the connections, is the condition normal, and are there any missing cotter pins?		<input type="radio"/>	<input type="radio"/>
Vehicle body	Frame and body	Are there any cracks, deformations, or corrosion?		<input type="radio"/>	<input type="radio"/>
		Are the mounting screws and nuts loose or missing?		<input type="radio"/>	<input type="radio"/>
	Vehicle cover	Are the mounting screws and nuts loose or missing?		<input type="radio"/>	<input type="radio"/>
		Are the mounting screws and nuts loose or missing?		<input type="radio"/>	<input type="radio"/>

	Label	Are there any stains or damages on the caution labels, etc.?	<input type="radio"/>	<input type="radio"/>	<input type="radio"/>
Transmission	V-belt	Whether the tension of the drive belt is appropriate, and whether there are cracks, damage, or dirt.	<input type="radio"/>	<input type="radio"/>	<input type="radio"/>
		Is the V-belt worn?	<input type="radio"/>	<input type="radio"/>	<input type="radio"/>
		Is the belt length within the reference value?		<input type="radio"/>	<input type="radio"/>
	Tension pulley	Is there any bouncing during operation?	<input type="radio"/>	<input type="radio"/>	<input type="radio"/>
Cutting mechanism	Lifting mechanism	Is the lifting smooth and without abnormal noise?	<input type="radio"/>	<input type="radio"/>	<input type="radio"/>
	Cutting handle	Are the bolts tightened?	<input type="radio"/>	<input type="radio"/>	<input type="radio"/>
	Cutter	Are the bolts tightened and is the wear serious?	<input type="radio"/>	<input type="radio"/>	<input type="radio"/>

4.3 List of refueling, water filling, grease and lubricating oil

Item	Supply (Exchange) Period	Recommended Variety	Capacity
Fuel	At any time	Automobile unleaded gasoline of No. 91 or higher or unleaded gasoline with an ethanol content of no more than 10% (E10)	10L
Engine oil	Replenish when daily inspection shows deficiency Exchange initial: 20 hours After the first time: Every 100 hours	Engine oil SAE Classification General Use: 10W-30 or 5W-30 Environment with starting/operating temperatures between 5°F (-15°C) and -13°F (-25°C): Full Synthetic 5W-30	1.7L
Walking Bearing	Every six months	Chassis Lubricating Grease Transmission Gear Grease API Classification GL4 or 5 SAE Classification #80	-
Reducer	Every six months	Mobil XHP222	
Charge or replace the battery	Anytime, when there is no power	Charge the remote control battery using the remote control charger; The power battery and starting battery are charged using 220V voltage	23Ah

4.4 List of Consumable Parts (Replacement Parts)

Attention			
When repairing or replacing parts of this product, be sure to use genuine parts from our company. If non-genuine parts from our company are used, our company may not provide warranty or other services for the product.			
Item	Replacement time	Type	Warranty period
V-shaped belt	Replace when defects are found	Rubber parts	3 months
Tire / Track	Replace when defects are found	Rubber parts	3 months
Cutter	Replace when defects are found	Metal parts	3 months
Lifting guide sleeve	Replace when defects are found	Nylon parts	3 months



Suggestion: It is best to replace the V-shaped belt after 100 hours of use.

Tire/track leakage or breakage due to external force is not covered by the warranty.

4.5 Engine

 Warning
<ul style="list-style-type: none">● The engine must be stopped during maintenance and servicing.● Avoid burns when the engine parts and oil are at high temperatures for a period of time after the engine is stopped. Please cool down before maintenance and servicing.

Checking, replenishing, and changing engine oil

 Warning
<ul style="list-style-type: none">● Dispose of waste oil in accordance with national laws and regulations.
 Attention
<ul style="list-style-type: none">● If oil is not replenished in time, the engine will malfunction. Therefore, please replenish the specified engine oil in time.

Suggestion:

- Please check the oil level before starting the engine or ten minutes after it is turned off. Because when the engine is turned off, there is still residual oil in various parts of the

vehicle, and the oil level cannot be detected normally.

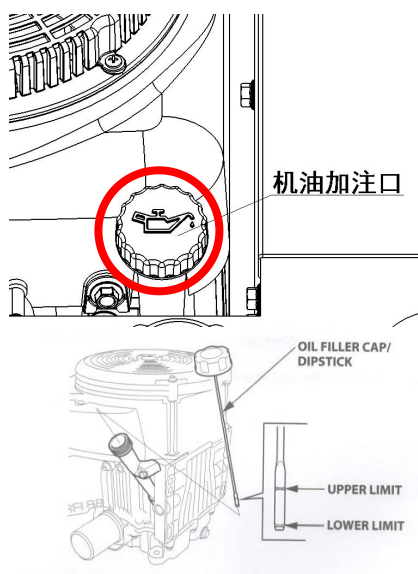

Check:

- 1) Park the vehicle on a level road.
- 2) Remove the oil filler plug (as shown in the figure on the right).
- 3) Check the oil dipstick.
- 4) Add oil if the oil level is low.
- 5) Test the oil dipstick; the oil level should be in the middle of the dipstick.
- 6) Install the oil filler cap.

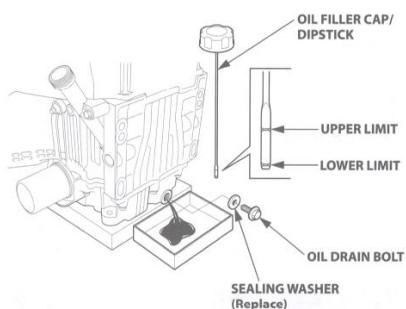

Oil change or oil filter replacement

- 1) Prepare a container for the oil.
- 2) Remove the oil drain plug and drain the oil.
- 3) Replace the oil filter (as shown in the figure on the right).
- 4) Install the oil drain plug and add new oil.
- 5) Test run the entire machine for 5 minutes.

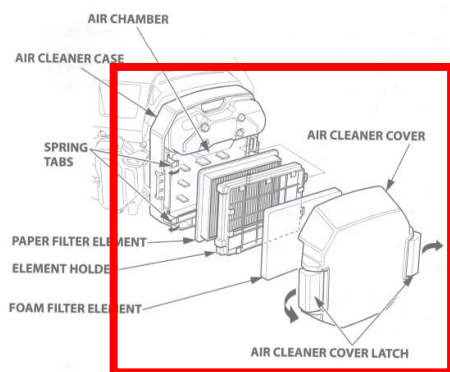
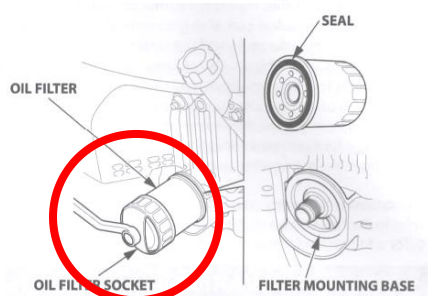

Note: Check the air filter daily after mowing. A dirty filter can cause engine failure, reduced power output, and shortened lifespan.

- 1) Open the air filter housing clips.
- 2) Open the housing, remove the air filter, release the two spring tabs from the filter element holder, remove the foam filter element from the holder, and remove the paper filter element.
- 3) Inspect both filter elements and replace if damaged. Always replace the paper filter element at the scheduled intervals.
- 4) If you want to reuse it, clean the filter element.

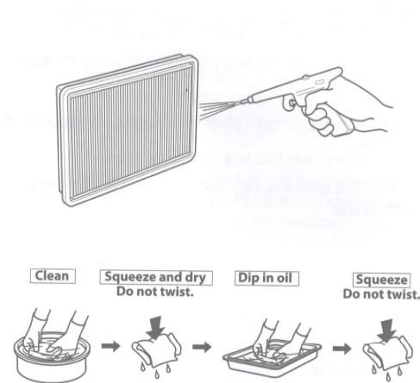

Paper Filter Element: Tap the filter element several times on a hard surface to remove dirt, or blow compressed air through the filter element from the clean side facing the engine [not exceeding 207 kPa (2.1 kgf/cm², 30 psi)]. Never try to brush off dirt; brushing will force dirt into the fibers. If the paper filter element is too dirty, replace it.

Foam Filter Element: Wash in warm soapy water, rinse thoroughly, and dry completely. Or wash in a nonflammable solvent and let dry. Dip the filter element in clean engine oil and squeeze out the excess oil. If too much oil remains in the foam, the engine will smoke upon starting.

- 5) Wipe away dirt from the inside of the air cleaner body and cover with a damp cloth. Use caution to prevent dirt from entering the carburetor air chamber.
- 6) Reinstall the paper filter element, place the foam filter element on the filter element holder, and then reinstall the filter element holder on the air filter housing. Hook the two spring tabs tightly.
- 7) Securely lock the air filter cover lock.

Caution: When removing the spark plug, hold the spark plug cap to remove it. Pulling the wire forcefully can break the wire. A loose spark plug can overheat and damage the engine. Over-tightening the spark plug can damage the threads in the cylinder head.

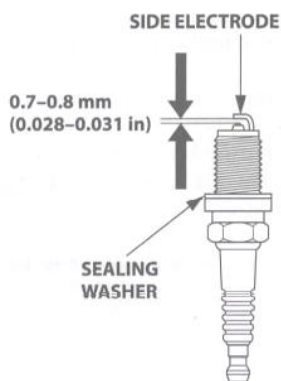
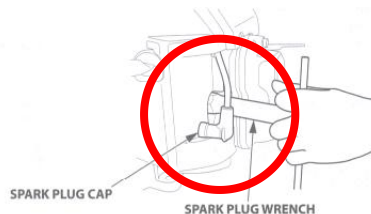

- 1) Disconnect the spark plug cap and clean the dirt around the spark plug area.
- 2) Remove the spark plug with a 5/8 inch spark plug wrench.
- 3) Inspect the spark plug: Replace if damaged, heavily fouled, gasket in poor condition, or electrodes worn.
- 4) Measure the spark plug electrode gap with a wire-type feeler gauge. If necessary, carefully bend the side electrode to correct the gap. The gap should be: 0.7-0.8 mm (0.028-0.031 inches).
- 5) Install the spark plug carefully by hand to avoid cross-threading.
- 6) After the spark plug is installed, tighten it with a 5/8 inch spark plug wrench to compress the seal gasket. When installing a new spark plug, tighten 1/2 turn to compress the gasket. When reinstalling the original spark plug, tighten 1/8-1/4 turn to compress the gasket.

Torque: 18.0 N•m (1.8 kgf•m, 13 lbf•ft)

Recommended spark plugs: ZER5F

(NGK)orFR2A (NGK)

4.6 Traveling Device



Warning

- Maintenance and repair must be performed with the engine stopped and the cutter disc confirmed to be stationary.
- When the engine has been stopped for a period of time, and the various parts or the engine itself are at high temperatures, please wait for them to cool down before performing maintenance to avoid burns.

Due to the inherent characteristics of rubber, it will loosen after a period of use. Pay attention to tightening it appropriately according to the usage, otherwise it is easy to cause belt detachment.

4.7 Post-use maintenance



Attention

- Do not wash the engine and chassis with water to avoid water immersion causing circuit failure or rust.
- Hard adhering substances can easily cause malfunctions, so please remove them thoroughly.
- If it cannot run due to hard adhering substances, do not force operation.

Normal post-use maintenance

- 1) Remove adhering substances such as grass or mud promptly after use.
- 2) Please park on hard, dry surfaces such as concrete ground.
- 3) Please store indoors.

Long-term storage method



Warning

- Do not store near fire to avoid fire hazards.

- 1) Please park in the order of 『Parking Method』.
- 2) Remove any adhering grass, mud, or other debris.
- 3) Apply grease to fasteners and rusted areas for rust prevention.
- 4) Charging the battery fully once a month will help extend its lifespan.
- 5) After the engine has cooled, drain the fuel tank and carburetor, cover the entire unit with a waterproof cover, and store it horizontally in a cool, dry place.
 - Disconnect the fuel line from the engine and drain the fuel from the fuel tank into an approved gasoline container. If the fuel tank is equipped with a valve, turn the fuel valve to the OPEN or ON position to enable draining. Reconnect the fuel line after draining is complete.
 - Loosen the carburetor drain screw and drain the fuel from the carburetor into an approved gasoline container. After draining is complete, tighten the carburetor drain screw.

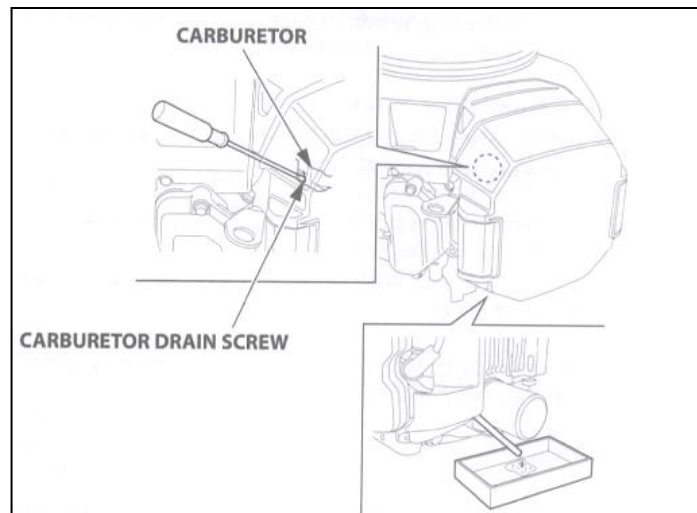

- If your engine stores gasoline in the tank and carburetor, it is very important to reduce the risk of gasoline vapor ignition. Choose a well-ventilated storage area away from any equipment with flames, such as furnaces, water heaters, or dryers. Also, avoid areas with electric motors that produce sparks, or areas where power tools are operated.
- If possible, avoid high-humidity storage areas, as this will promote rust and corrosion.
- Keep the fuel valve in the CLOSED or OFF position to reduce the possibility of fuel leakage unless all fuel has been drained from the fuel tank.
- Cover the engine after the engine and exhaust system have cooled to prevent dust from entering. Hot engines and exhaust systems can ignite or melt some materials.
- Do not use plastic sheets as dust covers.
- Non-porous covers will make it difficult for the machine to evaporate moisture, promoting rust and corrosion.

5. Troubleshooting

5.1 Problem Diagnosis Table



Attention

- If a problem occurs with this product, please stop using it. Refer to the following problem diagnosis table for appropriate handling. If a problem not listed in the following problem diagnosis table occurs, or if the problem is not resolved according to the troubleshooting page, please contact the sales outlet directly.
- The following troubleshooting content also includes a lot of specialized knowledge, as well as designated specialized tools, instruments, etc. If the customer cannot handle it personally, please contact the sales outlet.

Location of occurrence	Description of the problem	Reason	Handling
Remote control system	Remote control button not responding or display screen is off	Machine power is not turned on	Turn on the machine power switch
		Remote control power is not turned on (remote control indicator light shows red)	Turn on the remote control power switch
		Remote control has no battery or battery is dead	Install or replace the battery
		Machine power supply voltage is too low or no power	Charging
		Signal lost	Turn off the remote control and the mower, restart the mower, and then reconnect the remote control.
		Other (other than the above)	Contact the sales store
	Direction dial unresponsive	Remote control not turned on	Turn on the remote control power switch
		Check whether the machine is in MT driving mode and the speed control knob indicates position 0	Switch to AT driving mode or turn the speed control knob clockwise
		Other (except the above)	Contact the sales store
	The machine is not working	Emergency stop button not released	Emergency stop button released

Location of occurrence	Description of the problem	Reason	Handling
	Remote control display off	Remote control power switch not turned on	Remote control power switch turned on
		Emergency stop button not released	Emergency stop button released
		Remote control system normal, display damaged	Replace the display
		Remote control has no battery or battery is dead	Install or replace the battery
Indicator light	Tricolor light Red light on for 1s, off for 2s, flashing cyclically	Remote control connection abnormal or machine emergency stop connection abnormal	Check if the remote control's emergency stop is pressed, if the battery is low, or if there is strong magnetic interference; check if the panel's emergency stop is pressed.
	The tri-color light is solid red, and the buzzer is sounding.	There are obstacles in front of or behind the mower.	Remove obstacles in front of or behind the mower.
	The tri-color light flashes red rapidly, and the buzzer is sounding.	There are obstacles in front of and behind the mower.	Remove obstacles around the mower.
	The tri-color light flashes red and yellow alternately in a cycle (red light on for 1s, off for 1s, yellow light on for 1s, off for 1s), the buzzer is sounding, and the green light is off.	The temperature inside the control box is too high.	Stop using the mower and check the control box for any abnormalities.
	The buzzer sounds for 2s, then the yellow light of the tri-color light flashes twice (on for 1s, off for 1s), and the red and green lights are off.	Lawn mower Long standby, main power supply will be turned off soon	None

Location of occurrence	Description of the problem	Reason	Handling
	The red light of the tri-color light flashes twice (on for 1s, off for 1s, on for 1s, off for 2s) in a loop, the buzzer sounds, and the yellow and green lights are off.	Lawn mowerClimbing angle is too large	Lawn mower stopsclimbing, remotely control thelawn mower to a flat area
	The tri-color light green light, red light, and buzzer alarm simultaneously, the yellow light is off, and the alarm alternates every 2s.	Vehicle low battery alarm	The vehicle needs to be charged in time
	The tri-color light yellow light, red light, and buzzer alarm simultaneously, the green light is off, and the alarm alternates every 2s. The buzzer alarm stops after 1 minute.	Vehicle low fuel alarm	The vehicle needs to be refueled in time
	The red light of the tri-color light flashes 3 times (on for 1s, off for 1s, on for 1s, off for 1s, on for 1s, off for 2s) in a loop, the buzzer sounds, and the yellow and green lights are off.	Drive abnormality, machine motor abnormality	Check whether the traveling device is entangled with foreign objects and whether the motor circuit connection is normal. See the remote control screen instructions for details.

Location of occurrence	Description of the problem	Reason	Handling
Engine	Engine cannot be started or is difficult to start	No fuel	Refuel
		The temperature is too low	Start 3-5 times according to the starting method
		Spark plug ignition failure	Clean or replace
		Other (other than the above)	If it still cannot be started after starting according to 『Starting Method』, please contact the sales store.
	Flameout	Insufficient warm-up	Sufficient warm-up
	Engine suddenly stops	No fuel	Supply
		Other (other than the above)	Contact the sales store
	Poor idling (unstable engine rotation)	Air filter mesh clogged	Clean or replace
		Mesh clogged at the fan	Clean
		Other (other than the above)	Contact the sales store
Engine	Insufficient output or acceleration	Poor fuel quality	Replacement
		Air filter mesh clogged	Clean or replace
		Mesh clogged at the fan	Clean
		Overload	Load reduction
		Other (other than the above)	Contact the sales store
	Abnormal noise or vibration near the engine	Stop the engine and check for looseness in lifting and other components	Contact the sales store
	Excessive engine oil consumption		Contact the sales store or Honda after-sales service
	Overheating	Insufficient engine oil	Supply
	Fuel consumption is too fast	Air filter mesh clogged	Clean or replace
		Other (other than the above)	Contact the sales store
	Large amount of black smoke emitted (Poor condition)	Air filter mesh clogged	Replace with suitable engine oil
		Poor damper opening and closing	Check and open the damper
		Other (other than the above)	Contact the sales store
	Large amount of white smoke emitted (Poor condition)	Poor fuel quality	Exchange
		Engine oil viscosity is not suitable	Replace with suitable engine oil
		Excessive engine oil spills into the combustion chamber	Burn until no white smoke is emitted
		Other (other than the above)	Contact the sales store
Generator	High calorific value	Mesh blockage	Clean
	No power	Check the integrity and	Tighten or replace the

Location of occurrence	Description of the problem	Reason	Handling
	generation	tightness of the V-belt	V-belt
		Other (other than the above)	Contact the sales store
Walking Device	Unable to turn on the spot or walk in a straight line	Abnormal motor drive	Contact the sales store
		Other (other than the above)	Contact the sales store
	Brake or parking brake malfunction	Motor brake malfunction	Contact the dealer
		Abnormal brake line	Contact the dealer
Mowing device	Cutter does not rotate	Engine speed too low	Increase engine speed
		Safety clutch damaged	Replace safety clutch
	Abnormal vibration during operation	Cutter damaged or detached	Replacement
		Foreign object entry	Remove foreign objects
	Cut grass cannot be discharged smoothly	Grass has high humidity	Work after the grass is dry
		Cutting height is too low	Increase the cutting height
		Engine speed too low	Increase engine speed
		Working speed is too fast	Slow down the working speed
	Grass clippings remain after mowing	Grass is too long	Increase the cutting height
		Engine speed too low	Increase engine speed
		Working speed is too fast	Slow down the working speed
		Too much grass accumulation inside the cutter disc guard	Clear accumulated grass
	Blade rubs the ground	Cutting blade too low	Increase the cutting height
		Large undulations in terrain	Adjust mowing height according to terrain
		Cutting blade or blade holder bent	Replacement

5.2 Status Display Description Table

Location of occurrence	Display	Description	Interface and switching
Remote control display screen	RM or TM	Remote Control Mode or Tracking Mode(Always On)	Main Interface
	SA	Safety Tilt Angle Open (Always On), disappears after closing	Switching Method: Cutting
	SB	Emergency Stop Pressed	

Location of occurrence	Display	Description	Interface and switching
		(Always On), disappears after emergency stop is released	HeightDecreaseandCutter Speed DecreaseForkSimultaneouslyDown2sQuickly Return to Main Interface. (Note:Engine off and cutter speed decrease simultaneouslyDown2s Sequence switchToMain Interface)
	EI	Engine Ignition (Control Lights Up)	
	F/B/L/R/LF/LB/RF/RB	Directional Control (Control Lighting)	
	AT or MT	Driving mode (constant on)	
	OK	Self-check successful, drive normal (control point lights up)	
	IE	Vehicle inclination exceeds standard status (constant on after alarm)	
	Mm	Maintenance mode (constant on after alarm)	
	TA	Vehicle high temperature alarm status (constant on after alarm)	
	LB	Vehicle low battery alarm (constant on after alarm)	
	LO	Vehicle low fuel alarm (flashing after alarm)	
	X	Vehicle lateral deviation angle (constant on)	
	Y	Vehicle longitudinal deviation angle (constant on)	
	CS	Current speed km/h (always on)	
	TH	Total working time. Unit: hours (h)	Working time and mileage information interface
	PEOT	Pure electric running time. Unit: hours (h)	
	DS	Mower mileage. Unit: kilometers (km)	Switching Method: Engine off and cutter speed decreasing, simultaneouslymove down2sone sequential switch.
	EH	Engine working time Unit: hours (h)	
	MR1	MR1: 1500 1500 0 0 Description displayed from left to right: Right wheel motor speed. Revolver motor speed.	Motor speed information interface Switching Method: The engine shuts down and the cutter speed decreases while switching the secondary sequence by flicking down for 2 seconds.
	ACSI	ACSI: 00 00 01 00	Drive Information

Location of occurrence	Display	Description	Interface and switching
		Description displayed from left to right: Right wheel fault information. Left wheel fault information. 00: Normal state. 01: Overcurrent. 02: Temperature too high. 04: Low voltage. 08: Motor stall.	Interface Switching Method: Engine shuts down and cutter speed decreases while switching down 2s three times in sequence.
	ACV	ACV: 24 24 0 0 Description displayed from left to right: Right wheel drive current voltage; Left wheel drive current voltage.	
	VX	Vehicle lateral inclination angle Example: VX: 45 ° Unit: Degrees	Tilt Sensor Information Interface Switching Method: Engine shuts down and cutter speed decreases while switching down 2s four times in sequence.
	VY	Vehicle longitudinal tilt angle Example: VX: 45 ° Unit: Degrees	
	VZ	Vehicle heading tilt angle Example: VX: 45 ° Unit: Degrees	

VI. Key points for handling this product



Warning

- Please park the truck on a flat surface and secure the front wheels.
- During operation, please keep people away from the vehicle and the ramp.
- The ramp must be of high strength to withstand the weight of the machinery and the load. The width should be more than 2 times the width of the track / tire. The length should be 4 times higher than the truck or platform, and anti-slip treatment should be applied.
- Make sure the hook of the ramp is hooked on the platform and there are no fractures or misalignments.
- Please proceed slowly, preferably in MT mode, for loading.
- Please do not turn on the ramp, as it is easy to fall off the vehicle.
- Before transportation, make sure to secure the vehicle body to the truck bed.



- 1、Park the truck on a flat surface and secure the wheels.
- 2、Make sure the hook of the ramp is hooked on the platform and there are no fractures or misalignments.
- 3、Please proceed slowly and load the vehicle.
- 4、Park according to the order of 『Parking Method』 and secure the vehicle to the truck bed with steel wire or rope.

7. Regarding Warranty and After-sales Service

7.1 Regarding Warranty

Note: When repairing or replacing parts of this product, be sure to use genuine parts from our company. If non-genuine parts from our company are used, our company will not provide warranty or other services for the product.			
Item	Replacement time	Type	Warranty period
Engine	Replace when defects are found	Key Components	1 year
Generator	Replace when defects are found	Key Components	1 year
Controller	Replace when defects are found	Key Components	1 year
Motor	Replace when defects are found	Key Components	1 year
Reducer	Replace when defects are found	Key Components	1 year
Driver	Replace when defects are found	Key Components	1 year
Remote Control	Replace when defects are found	Key Components	1 year
V-shaped belt	Replace when defects are found	Consumable Rubber Parts	3 months
Tires/Tracks	Replace when defects are found	Consumable Rubber Parts	3 months
Cutter	Replace when defects are found	Consumable metal parts	3 months
Lifting guide sleeve	Replace when defects are found	Expendable nylon parts	3 months

This product comes with a warranty certificate, please check it

7.2 About after-sales service

If you encounter problems during use, or have questions, or require after-sales service, please contact the sales store or our company's after-sales service center directly. When contacting us, please provide the manufacturing number on the model label, the engine brand and model, and other relevant product information. For the engine brand name and model name of the configuration, please refer to the [Technical Parameters] in the instruction

manual.

7.3 About the supply period of parts (period)

The supply period for individual parts of this product is up to three years after the cessation of manufacturing.